

“A library is not a luxury, but one of the necessities of life.” -H.W. Beecher

DONATE

CAPITAL CAMPAIGN COMMITTEE

- Ann Adrian
Retired Educator, Community Advocate
- Angela Becker
Director of Finance, Corporate Lodging Consultants
- Tami Carlgren
Community Advocate
- Cari Cusick
Director, Newton Public Library
- Rochelle Glover
Retired Educator, USD #373
- Mike Farrell
Retired, Development, Southwestern College
- Larry Lee
Pastor, All Nations Church
- Nathan Murphy
Commercial Relationship Manager, INTRUST Bank
- Charlie Robinson
Funeral Director, Petersen’s Funeral Home
- Angie Tatro
CEO, Central Kansas Community Foundation



Above: Concept drawing of the interior, community space within the library.

YOUR DONATION WILL CREATE A SPACE WHERE COMMUNITY CONNECTS.

Donations or commitments must be secured by Fall 2022 for the project to remain on schedule. Committed gifts can be made over a five-year period. The campaign can accept gifts of cash, securities, trusts, bequests, insurance, and real property. Contact any member of the fundraising committee below to discuss your planned gift or to make a direct contribution to the campaign. We appreciate your consideration and your support.

Ann Adrian, campaign co-chair, 316-283-5654
 Angela Becker, campaign co-chair, 707-536-7101
 Cari Cusick, library director, 316-283-2890



Scan the QR Code to make a direct cash contribution or visit www.bit.ly/nplf-campaign to donate online.

The “Where Community Connects” campaign is an initiative of the Newton Public Library Foundation, an affiliate of the CKCF.

Newton Public Library

WHERE COMMUNITY CONNECTS

Capital Campaign

Libraries today are expanding their missions. While still providing traditional services, public libraries serve as community hubs - creating opportunities, empowering residents, and contributing to an increased quality of life. A new facility will allow future generations to connect to resources, their communities, and the world around them.



THE VISION

Public libraries are essential to communities, fostering literacy and lifelong learning. The design of the new library furthers the library's role as a community hub. New features and updated technology allow users to not only access books and information, but also to study, work, connect, and create. Accessible facilities make programs and services available to everyone, and the flexibility embedded in the design will allow the library to serve our communities for generations to come.

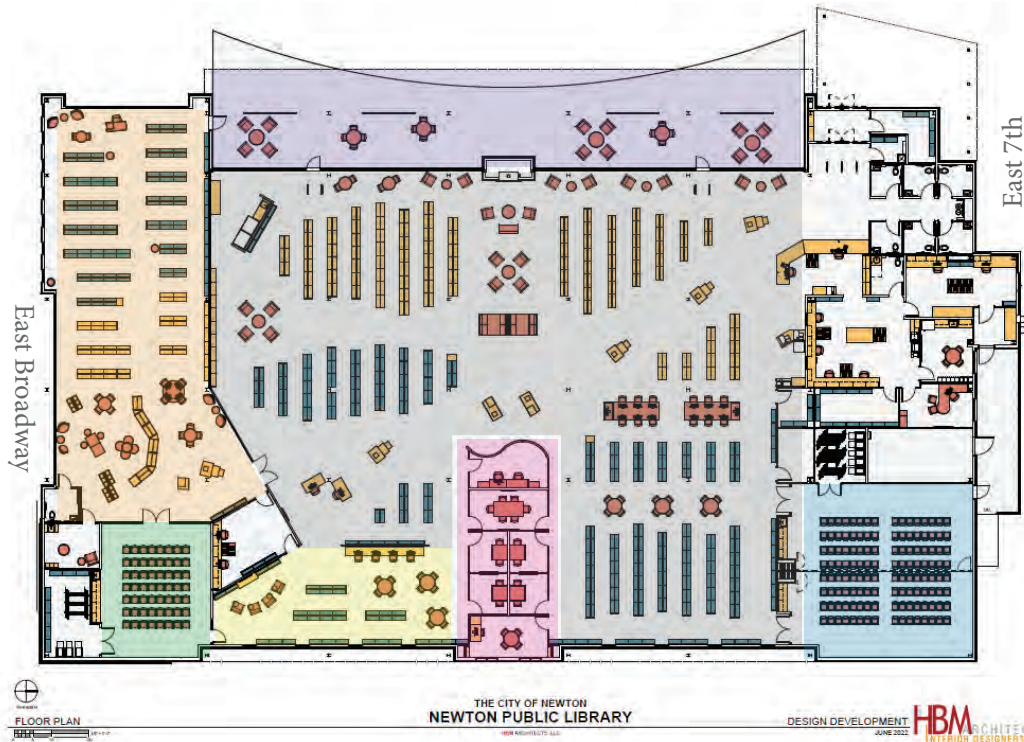

KEY FEATURES

LIBRARY CENTRAL

Open, expansive space housing books, media, computers, and more. Seating areas provide a welcoming atmosphere, and areas for work and study support both educational and professional pursuits.

YOUNG ADULT AREA

Giving teens and young adults their own space in the new library, this area hosts a high-quality collection of young adult books and media, as well as gathering areas, a gaming zone, and digital access.

OUTDOOR GATHERING SPACE

Library Central's west veranda looks out on the central portion of Military Park, providing a natural anchor for a community gathering place and large-event venue. Because the new library is built to the east of the current facility, Military Park becomes more open and accessible to large groups. The historic cannon and locomotive remain as iconic features of the park.

CHILDREN'S LIBRARY

Promoting early literacy and helping children become lifelong readers, this dedicated space features a "play, learn and grow" area where parents and caregivers can spend time engaging with their children.

STUDY AND MEETING ROOMS

With up-to-date technology, these spaces allow users to meet locally and to connect virtually. A second, smaller room is located just off the children and young adult areas, and will be used primarily for youth programming such as story time, game zone, and Summer Reading Program events.

OTHER AMENITIES

The new library features a drive-through service window for convenient access. Restrooms are updated and accessible. A single-floor layout creates access for people of all ages and abilities. Higher ceilings and natural light create an enjoyable and inviting environment. Up-to-date technology supports digital initiatives and access.

\$10 MILLION

\$300,000 Remaining

Private Donors
\$2.4 Million
Committed to Date

Newton Public Library
\$2.7 Million
Commitment

City of Newton
\$4.5 Million
Commitment

THE COMMITMENT

In order to make the new library a reality, we need to raise \$2.7 million in private donations to augment funding from the City of Newton and Newton Public Library toward the \$10 million project. As of July 2022, we are within several hundred thousand dollars of reaching the fundraising goal.

To keep the project on schedule, these funds need to be raised or committed by fall of 2022.

Thank you very much to our local businesses, private donors and the City of Newton for your commitment to making this vision a reality for Newton and the larger Harvey County community.